

UNISTRUT® P1000®

STRUT SYSTEMS

STRUT

P1000®

PL/GB/HG

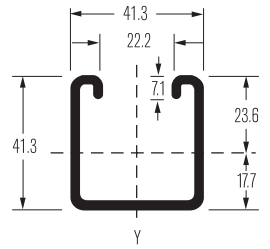
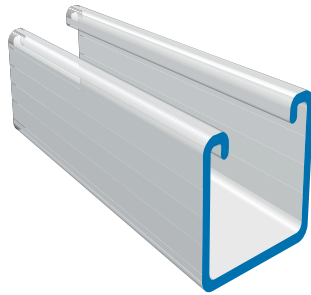

Mass: 2.59kg/m

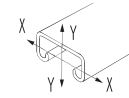

A	-	330mm ²
kg/m	-	2.59kg/m
I _{x-x}	=	0.069 10 ⁶ mm ⁴
Z _{x-x}	=	2.920 10 ³ mm ³
r _{x-x}	=	14.5mm
I _{y-y}	=	0.092 10 ⁶ mm ⁴
Z _{y-y}	=	4.451 10 ³ mm ³
r _{y-y}	=	16.7mm

L(mm)	Fmax(kN)	fmax(mm)	F(kN)
250	14.83	0.22	45.51
500	7.42	0.87	36.84
750	4.94	1.97	28.22
1000	3.71	3.50	21.44
1250	2.97	5.46	16.42
1500	2.47	7.87	13.20
1750	2.12 (2)	10.71	11.00
2000	1.85 (2)	13.99	9.35
2250	1.65 (2)	17.70	8.05
2500	1.48 (2)	21.85	7.01
2750	1.35 (2)	26.44	6.14
3000	1.24 (2)	31.47	-

Part No.	Material Thickness	Length
P1000-PL	2.5mm	6m
P10003-PL	2.5mm	3m
P1000-GB	2.5mm	6m
P10003-GB	2.5mm	3m
P1000-HG	2.5mm	6m
P10003-HG	2.5mm	3m

(2) See Note 2 Page 9

P1000T

PL/GB/HG

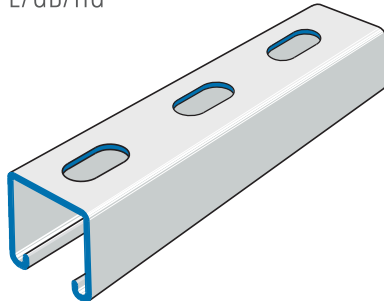

Slots 14 wide x 28 long at 50mm centres (approx.)

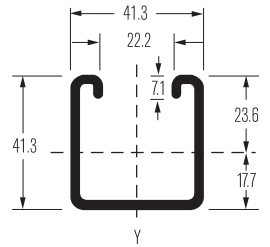

Mass: 2.32kg/m

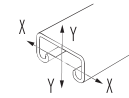

A	-	295mm ²
kg/m	-	2.32kg/m
I _{x-x}	=	0.059 10 ⁶ mm ⁴
Z _{x-x}	=	2.698 10 ³ mm ³
r _{x-x}	=	14.1mm
I _{y-y}	=	0.091 10 ⁶ mm ⁴
Z _{y-y}	=	4.423 10 ³ mm ³
r _{y-y}	=	17.6mm

L(mm)	Fmax(kN)	fmax(mm)	F(kN)
250	13.35	0.20	40.96
500	6.68	0.78	33.16
750	4.49	1.77	25.40
1000	3.34	3.15	19.30
1250	2.67	4.91	14.78
1500	2.22	7.08	11.88
1750	1.91 (2)	9.64	9.90
2000	1.66 (2)	12.59	8.41
2250	1.48 (2)	15.93	7.24
2500	1.33 (2)	19.66	6.31
2750	1.21 (2)	23.80	5.53
3000	1.12 (2)	28.32	-

Part No.	Material Thickness	Length
P1000T-PL	2.5mm	6m
P10003T-PL	2.5mm	6m
P1000T-GB	2.5mm	6m
P10003T-GB	2.5mm	3m
P1000T-HG	2.5mm	6m
P10003T-HG	2.5mm	3m

(2) See Note 2 Page 9

UNISTRUT® P2000

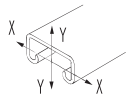

A - 228mm²
 kg/m - 1.79 kg/m
 I_{x-x} = 0.052 10⁶mm⁴
 Z_{x-x} = 2.297 10³mm³
 r_{x-x} = 15.2mm
 I_{y-y} = 0.065 10⁶mm⁴
 Z_{y-y} = 3.143 10³mm³
 r_{y-y} = 16.9mm

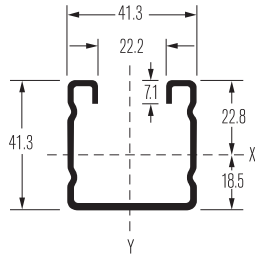



Mass: 1.79kg/m

PL/GB/HG

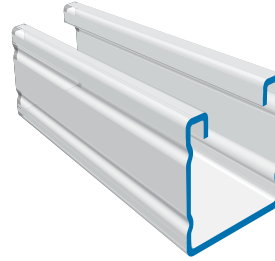
P2000

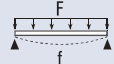
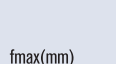
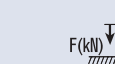

Part No.	Material Thickness	Length	L(mm)		Fmax(kN)		Fmax(kN)
							
P2000-PL	1.6mm	6m	250	10.30	0.20	32.92	
P20003-PL	1.6mm	3m	500	6.06	0.94	26.55	
P2000-GB	1.6mm	6m	750	4.04	2.12	19.21	
P20003-GB	1.6mm	3m	1000	3.03	3.77	12.91	
P2000-HG	1.6mm	6m	1250	2.42	5.89	9.03	
P20003-HG	1.6mm	3m	1500	2.02	8.48	6.89	
			1750	1.73 (2)	11.54	5.56	
			2000	1.27 (2)	8.41	5.46	
			2250	1.35 (2)	19.07	4.02	
			2500	1.21 (2)	23.55	3.53	
			2750	1.10 (2)	28.49	3.14	
			3000	1.01 (2)	33.91	2.82	

(2) See Note 2 Page 9

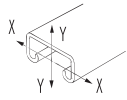

A - 206mm²
 kg/m - 1.62kg/m
 I_{x-x} = 0.045 10⁶mm⁴
 Z_{x-x} = 2.136 10³mm³
 r_{x-x} = 14.7mm
 I_{y-y} = 0.065 10⁶mm⁴
 Z_{y-y} = 3.125 10³mm³
 r_{y-y} = 17.7mm

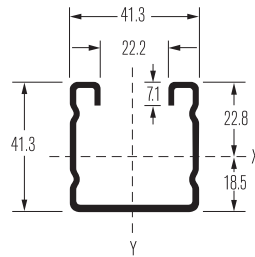



Mass: 1.62kg/m

Slots 11 wide x 28 long at 50mm centres (approx.)

PL/GB/HG

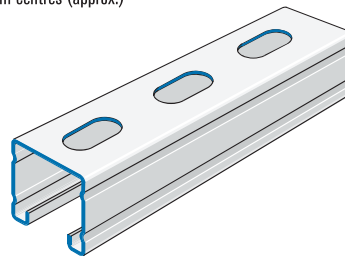
P2000T

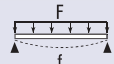
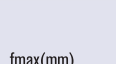

Part No.	Material Thickness	Length	L(mm)		Fmax(kN)		Fmax(kN)
							
P2000T-PL	1.6mm	6m	250	9.27	0.18	29.63	
P20003T-PL	1.6mm	3m	500	5.45	0.85	23.90	
P2000T-GB	1.6mm	6m	750	3.64	1.91	17.29	
P20003T-GB	1.6mm	3m	1000	2.73	3.39	11.62	
P2000T-HG	1.6mm	6m	1250	2.18	5.30	8.13	
P20003T-HG	1.6mm	3m	1500	1.82	7.63	6.20	
			1750	1.56 (2)	10.39	5.00	
			2000	1.14 (2)	7.57	4.91	
			2250	1.22 (2)	17.16	3.62	
			2500	1.09 (2)	21.20	3.18	
			2750	0.99 (2)	25.64	2.83	
			3000	0.91 (2)	30.52	2.54	

(2) See Note 2 Page 9

P3300

PL/GB/HG

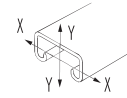
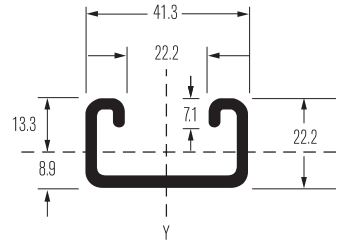
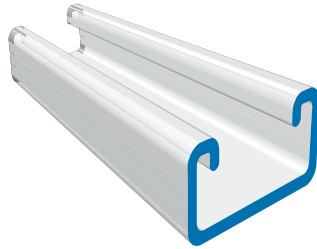

A	-	232mm ²
kg/m	-	1.82 kg/m
I x-x	=	0.013 10 ⁶ mm ⁴
Z x-x	=	0.999 10 ³ mm ³
r x-x	=	76mm
I y-y	=	0.055 10 ⁶ mm ⁴
Z y-y	=	2.661 10 ³ mm ³
r y-y	=	15.4mm

Mass: 1.82kg/m

L(mm)	Fmax(kN)	fmax(mm)	F(kN)
250	5.52	0.42	34.88
500	2.76	1.68	27.76
750	1.84	3.79	19.42
1000	1.38	6.74	12.08
1250	1.10	10.53	7.90
1500	0.92	15.16	5.56
1750	0.79 (2)	20.63	-
2000	0.69 (2)	26.95	-
2250	0.61 (2)	34.11	-
2500	0.55 (2)	42.11	-
2750	0.50 (2)	50.95	-
3000	0.46 (2)	60.63	-

Part No.	Material Thickness	Length
P3300-PL	2.5mm	6m
P33003-PL	2.5mm	3m
P3300-GB	2.5mm	6m
P33003-GB	2.5mm	3m
P3300-HG	2.5mm	6m
P33003-HG	2.5mm	3m

(2) See Note 2 Page 9

P3300T

PL/GB/HG

Slots 14 wide x 28 long at 50mm centres (approx.)

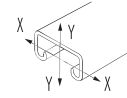
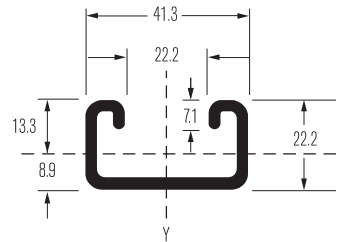
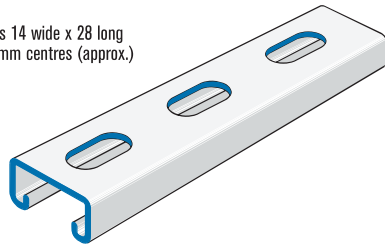

A	-	197mm ²
kg/m	-	1.55kg/m
I x-x	=	0.011 10 ⁶ mm ⁴
Z x-x	=	0.912 10 ³ mm ³
r x-x	=	75mm
I y-y	=	0.054 10 ⁶ mm ⁴
Z y-y	=	2.634 10 ³ mm ³
r y-y	=	16.6mm

Mass: 1.55kg/m

L(mm)	Fmax(kN)	fmax(mm)	F(kN)
250	4.97	0.38	31.39
500	2.48	1.51	24.98
750	1.66	3.41	17.48
1000	1.24	6.07	10.87
1250	0.99	9.48	7.11
1500	0.83	13.64	5.00
1750	0.71 (2)	18.57	-
2000	0.62 (2)	24.26	-
2250	0.55 (2)	30.70	-
2500	0.50 (2)	37.90	-
2750	0.45 (2)	45.86	-
3000	0.41 (2)	54.57	-

Part No.	Material Thickness	Length
P3300T-PL	2.5mm	6m
P33003T-PL	2.5mm	3m
P3300T-GB	2.5mm	6m
P33003T-GB	2.5mm	3m
P3300T-HG	2.5mm	6m
P33003T-HG	2.5mm	3m

(2) See Note 2 Page 9

UNISTRUT® P4000

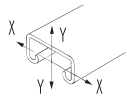

A - 160mm²
 kg/m - 1.26kg/m
 I_{x-x} = 0.010 10⁶mm⁴
 Z_{x-x} = 0.786 10³mm³
 r_{x-x} = 7.8mm
 I_{y-y} = 0.039 10⁶mm⁴
 Z_{y-y} = 1.880 10³mm³
 r_{y-y} = 15.6mm

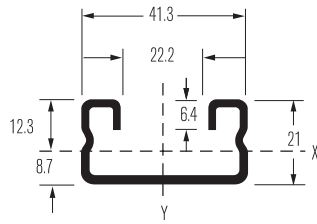

Mass: 1.26kg/m

PL/GB/HG

P4000



Part No.	Material Thickness	Length	L(mm)	F		F(kN)
				F _{max} (kN)	fmax(mm)	
P4000-PL	1.6mm	6m	250	4.20	0.44	22.36
P40003-PL	1.6mm	3m	500	2.10	1.77	16.30
P4000-GB	1.6mm	6m	750	1.40	3.98	10.46
P40003-GB	1.6mm	3m	1000	1.05	7.08	6.54
P4000-HG	1.6mm	6m	1250	0.84	11.07	4.54
P40003-HG	1.6mm	3m	1500	0.70 (2)	15.94	3.35
			1750	0.60 (2)	21.69	-
			2000	0.52 (2)	28.33	-
			2250	0.47 (2)	35.86	-
			2500	0.42 (2)	44.27	-
			2750	0.38 (2)	53.57	-
			3000	0.35 (2)	63.57	-

(2) See Note 2 Page 9

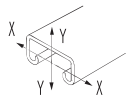

A - 138mm²
 kg/m - 1.08kg/m
 I_{x-x} = 0.008 10⁶mm⁴
 Z_{x-x} = 0.729 10³mm³
 r_{x-x} = 7.6mm
 I_{y-y} = 0.038 10⁶mm⁴
 Z_{y-y} = 1.862 10³mm³
 r_{y-y} = 16.7mm

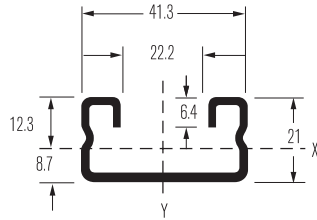

Mass: 1.08kg/m

PL/GB/HG

P4000T

Slots 11 wide x 28 long
 at 50mm centres (approx.)

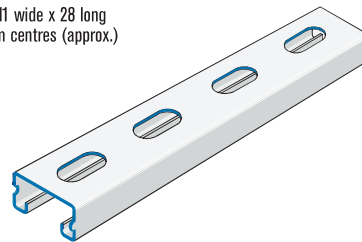

Part No.	Material Thickness	Length	L(mm)	F		F(kN)
				F _{max} (kN)	fmax(mm)	
P4000T-PL	1.6mm	6m	250	3.78	0.40	20.12
P40003T-PL	1.6mm	3m	500	1.89	1.59	14.67
P4000T-GB	1.6mm	6m	750	1.26	3.58	9.41
P40003T-GB	1.6mm	3m	1000	0.95	6.37	5.89
P4000T-HG	1.6mm	6m	1250	0.76	9.96	4.09
P40003T-HG	1.6mm	3m	1500	0.63 (2)	14.35	3.02
			1750	0.54 (2)	19.52	-
			2000	0.47 (2)	25.50	-
			2250	0.42 (2)	32.27	-
			2500	0.38 (2)	39.84	-
			2750	0.34 (2)	48.21	-
			3000	0.32 (2)	57.21	-

(2) See Note 2 Page 9